

# OVERVIEW

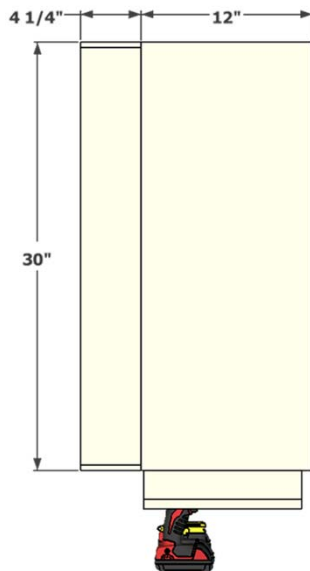
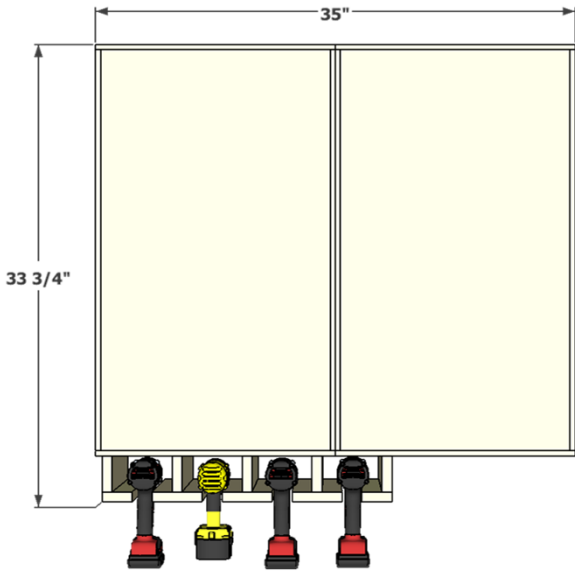
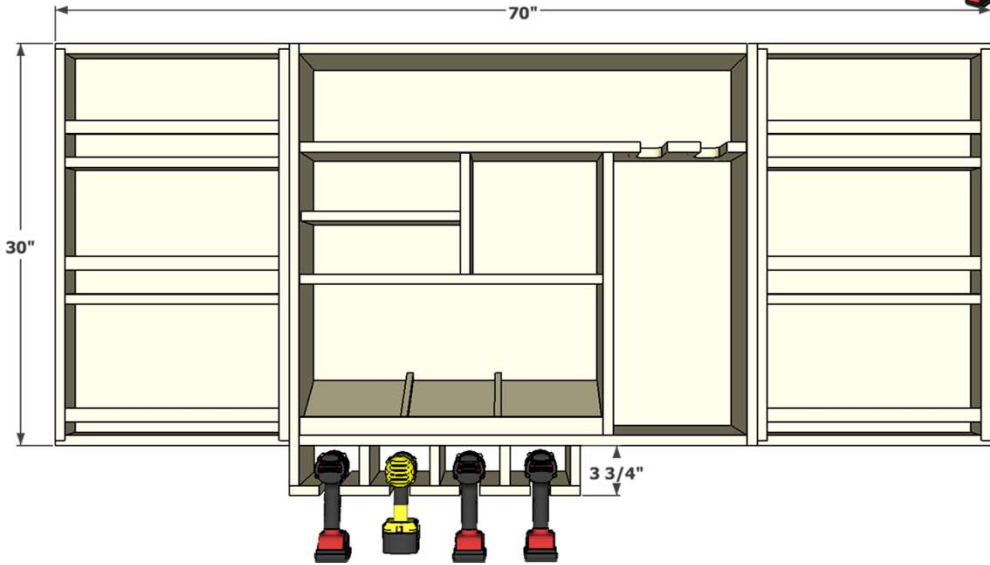
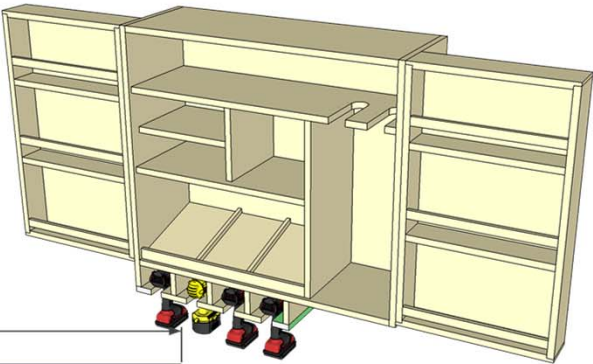

# PART LIST & CUTTING DIAGRAM

Part	Description	Qty	Dimensions	Material
A	Case Top & Bottom Panel	2	33-1/2" x 12" x 3/4"	3/4" Plywood
B	Top Horizontal Shelf	1	33-1/2" x 11" x 3/4"	3/4" Plywood
C	Vertical Partition	1	21-3/16" x 11 x 3/4"	3/4" Plywood
D	Small Horizontal Shelf	1	12" x 10" x 3/4"	3/4" Plywood
E	Short Side Panel	1	30" x 12" x 3/4"	3/4" Plywood
F	Long Side Panel	1	33" x 12" x 3/4"	3/4" Plywood
G	Medium Horizontal Shelf	1	22-3/4" x 11" x 3/4"	3/4" Plywood
H	Drill Hanger Vertical Spacer	4	3" x 12" x 3/4"	3/4" Plywood
I	Drill Hanger Horizontal Shelf	3	3-3/4" x 12" x 3/4"	3/4" Plywood
J	Outer Drill Hanger Horizontal Shelf	2	2-1/4" x 12" x 3/4"	3/4" Plywood
K	Door Shelf	4	3-1/2" x 12" x 3/4"	3/4" Plywood
L	Door Panel	2	29-1/4 x 16-3/4 x 3/4"	3/4" Plywood
M	Small Vertical Partition	1	9-1/8" x 10" x 3/4"	3/4" Plywood
N	Battery Charging Platform	1	22-1/4" x 11" x 1/2"	1/2" Plywood
O	Charging Platform Cleat (Cut in 2)	1	3-1/16" x 10-1/2 x 1/2"	1/2" Plywood
P	Charging Platform Lip	1	1-3/8" x 11" x 1/2"	1/2" Plywood
Q	Back Panel	1	33-1/2" x 28-7/16" x 1/2"	1/2" Plywood
R	Shelf Rail	12	1-1/4" x 16" x 1/2"	1/2" Plywood
S	Door Rail	4	17-1/2" x 4-1/4" x 3/4"	Lumber
T	Door Stile	4	29-1/4" x 4-1/4" x 3/4"	Lumber

## 1 Sheet 4'x8' - 3/4" Plywood

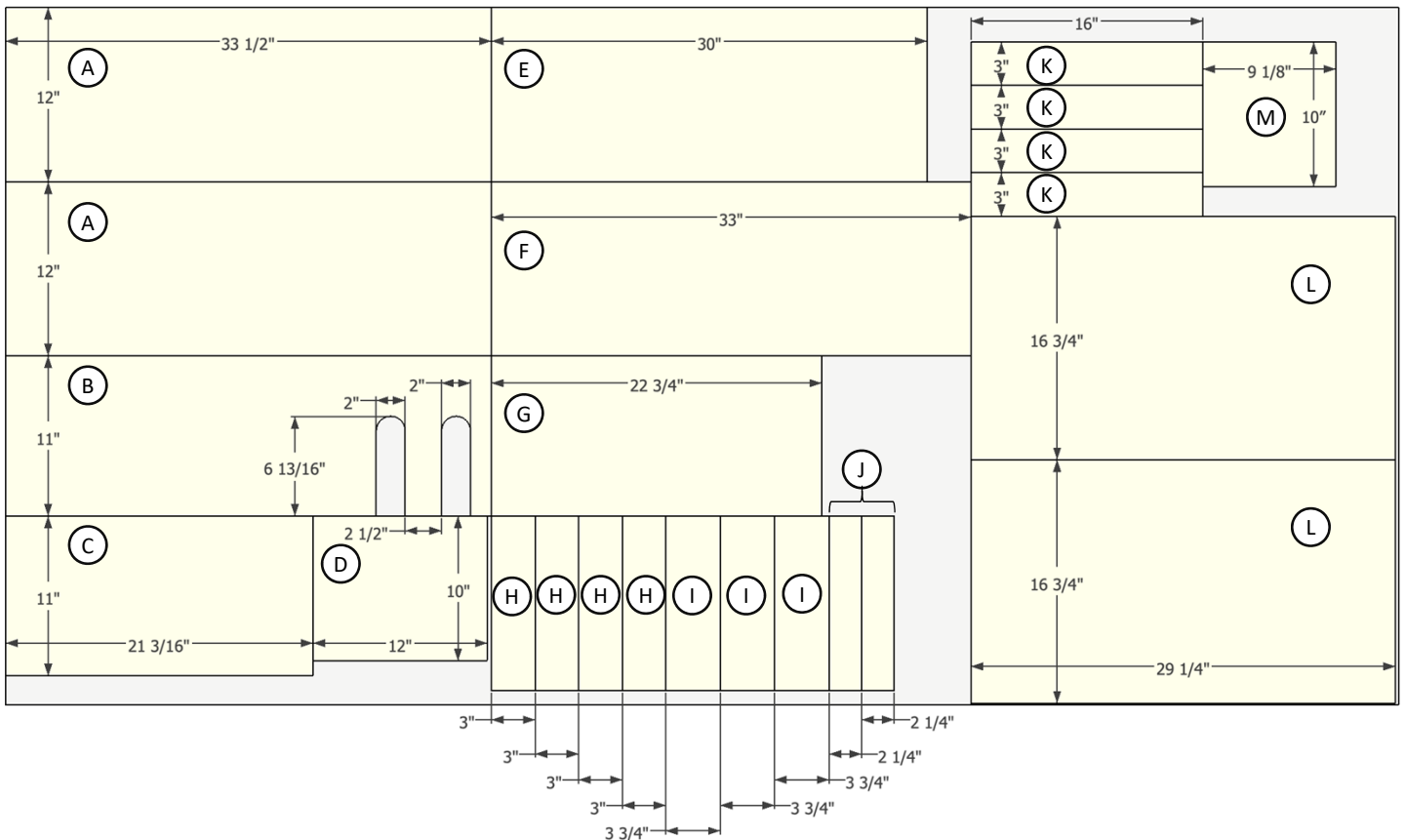

# PART LIST & CUTTING DIAGRAM CONT.

1 Sheet 4'x4' - 1/2" Plywood

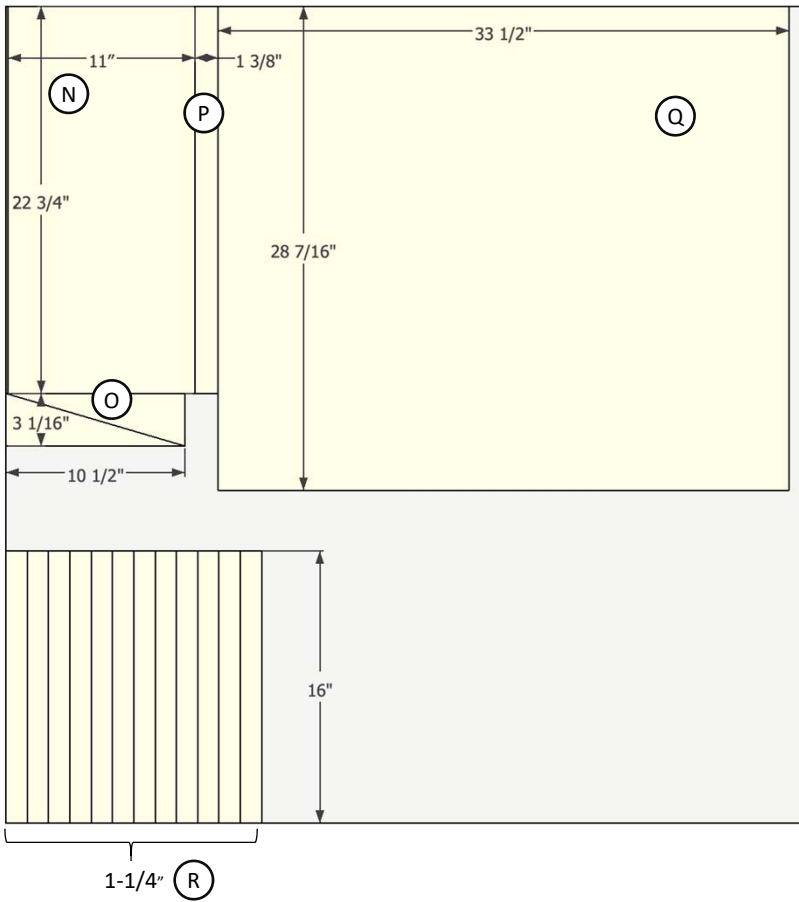

Lumber

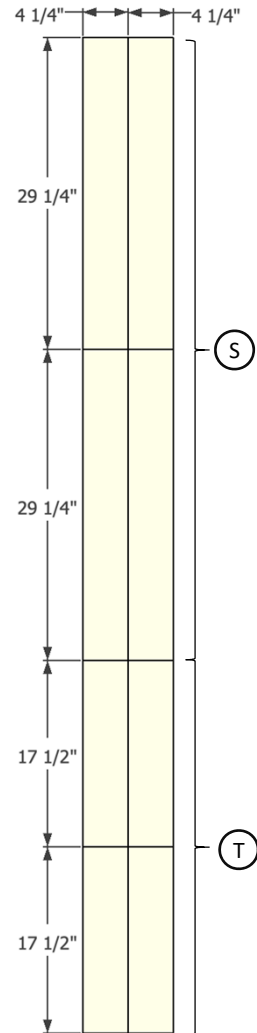

**Step 1:** After the short side panel (E) and the bottom panel (A) cut to size, drill holes to the bottom face of the bottom panel and attach the two panels together using glue and 1-1/4" pocket screws. All joints will use 1-1/4" pocket screws throughout the plan unless otherwise noted.

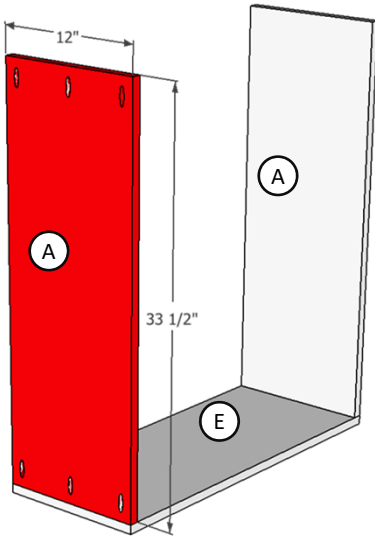
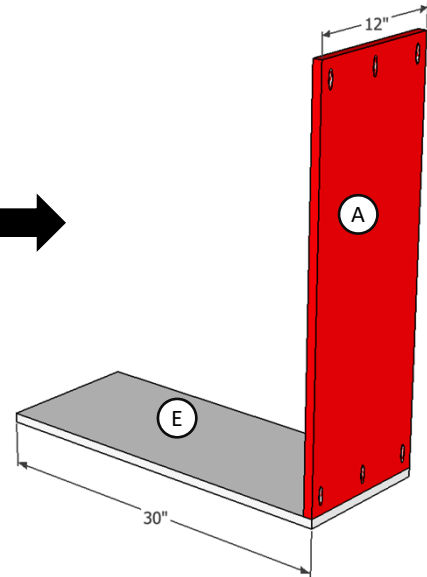

**Step 2:** Attach the top panel (A) to the short side panel (E).

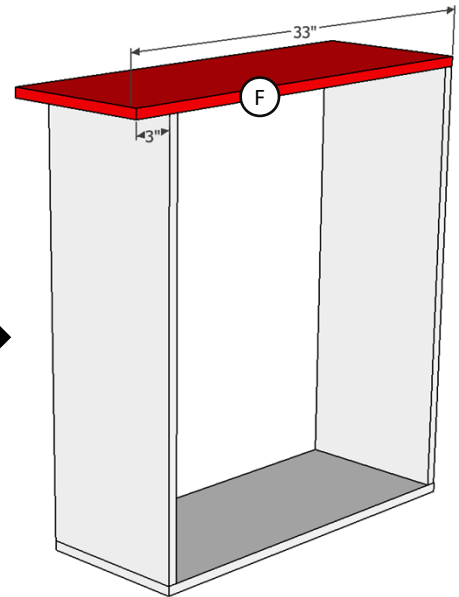

**Step 3:** Attach the long side panel (F) to complete the cabinet carcass. The amount of overhang on panel (F) should be equal to the length difference between it and panel E. Check to make sure that length is consistent from front to back. This will help to ensure the squareness of the carcass.

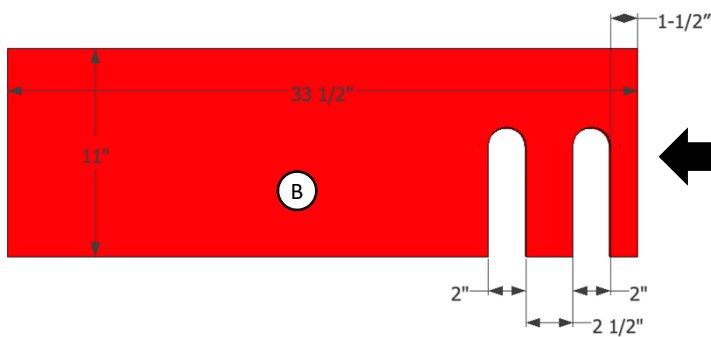

**Step 4:** Use the inside dimensions of the carcass to determine the length of the top shelf (B). If shelf will also be used as a tool hanger, measure the proper length and width of the cutouts for holding the tools, as well as the proper spacing between the tools. Then use a Forstner bit to cut the hole, and two straight cuts tangent to the hole to complete the tool hangers.

**Step 5:** Make sure the depth of the top shelf (B) is short enough to allow for a 1/2" back panel later. Then proceed to drill pocket holes on the top face of the shelf before attaching it to the carcass.

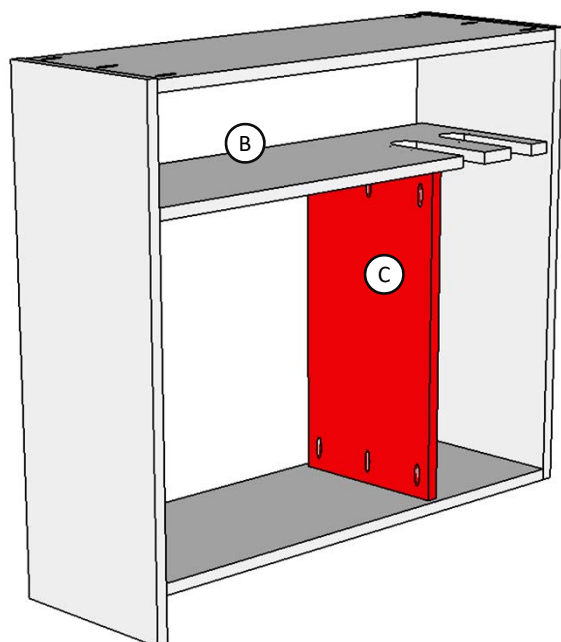
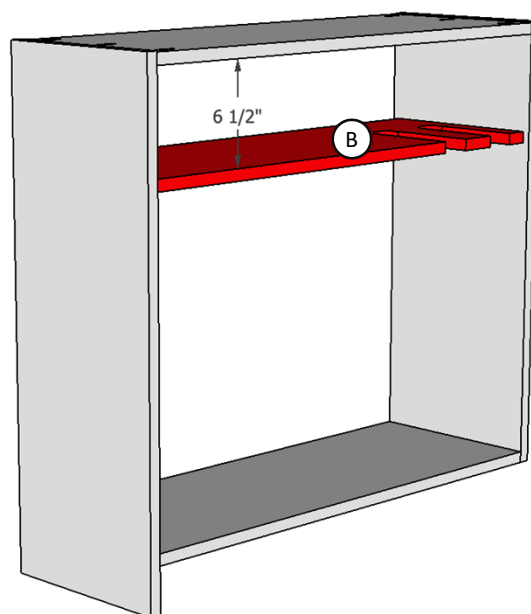

**Step 6:** Cut the vertical partition (C) to size to fit in between the horizontal shelf (B) and the bottom panel (A). Use a spacer block to get enough clearance between the tool hanging on the horizontal shelf and the vertical partition. Drill pocket holes on the two ends and attach to the assembly.

**Step 7:** Flip the case on to its left side. Cut the small horizontal shelf (D) to size and cut pocket holes on both ends of the bottom face. Then use a couple of spacer blocks to get a consistent 4-3/8" spacing from the top horizontal shelf (B) to attach it to the case.

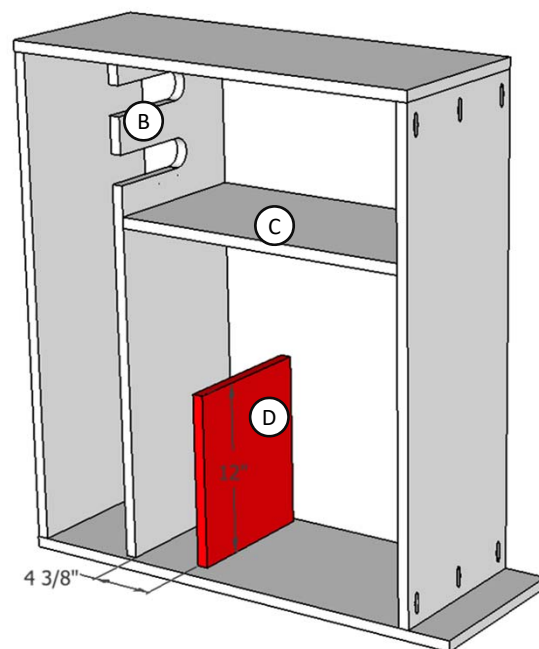

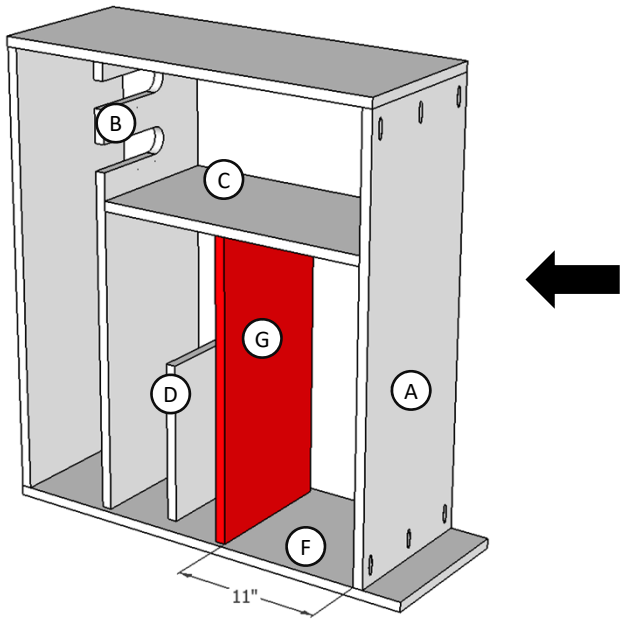

**Step 8:** Cut the medium horizontal shelf (G) to fit between the vertical partition (C) and the long side panel (F). Drill pocket holes on both ends of the bottom face. The spacing between the bottom panel (A) and the medium horizontal shelf (G) should be a minimum of 10" to keep enough hand clearance to install and remove batteries from the chargers later.

**Step 9:** With the small vertical partition (M) cut to size, slide it between the top and medium horizontal shelves, and resting on the small horizontal shelf (D). There's no need to drill pocket holes for this.

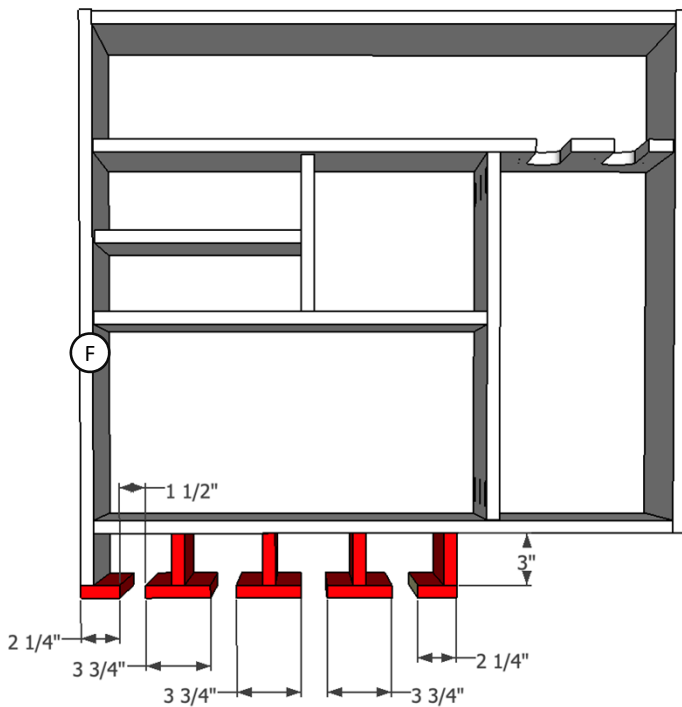
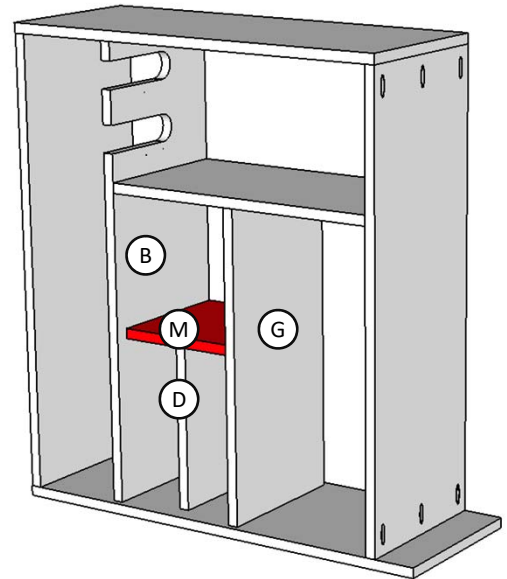

**Step 10:** Cut all the pieces for the drill hangers to size. The vertical spacers (H) should be the same height as the amount over overhang on the left side panel (A). Center the vertical spacers to the three middle horizontal shelves (I) and attach them with glue and 1-1/4" screws.

Attach one of the outer horizontal shelves (J) to the bottom edge of the long side panel (F) first. Then using a 1-1/2" spacer block, begin attaching the rest of the T-assemblies to the bottom of the case using glue and 1-1/4" screws.

**Step 11:** Cut the back panel (Q) to size to fit the cabinet. Use brad nails and glue to attach the panel to the vertical partitions and horizontal shelves, and then secure it to the top and bottom panels (A) with countersunk 1-1/4" wood screws.

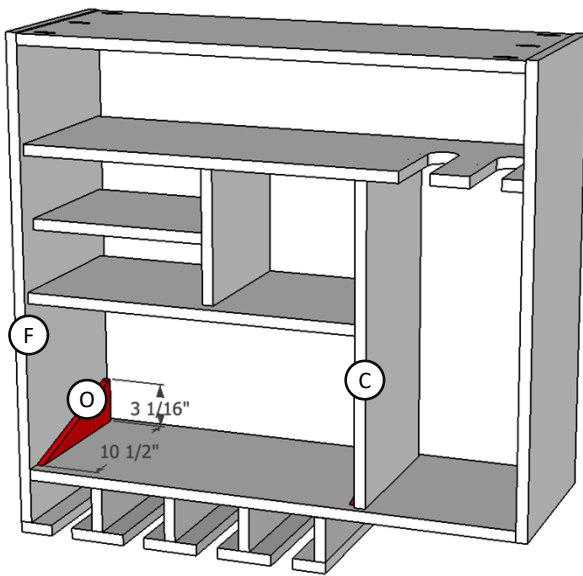
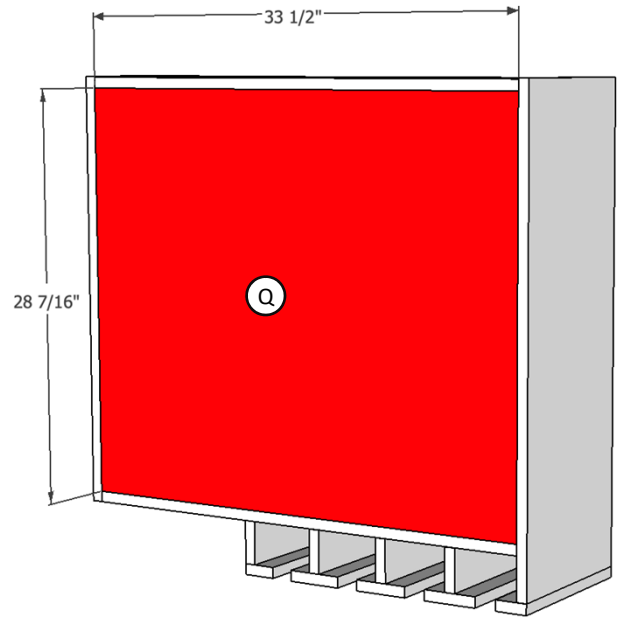

**Step 12:** Cut the charging platform cleats (O) to size. Cut the triangular shape with a crosscut sled or miter gauge. Then attach the cleats to the long side panel (F) and the vertical partition (C) using glue and brad nails.

**Step 13:** Cut the battery charging platform (N) to width and then use an angle gauge to transfer the angle of the cleat to the table saw to cut the platform to depth. This ensures the front and back edges of the panel will be vertical after it's secured in place.

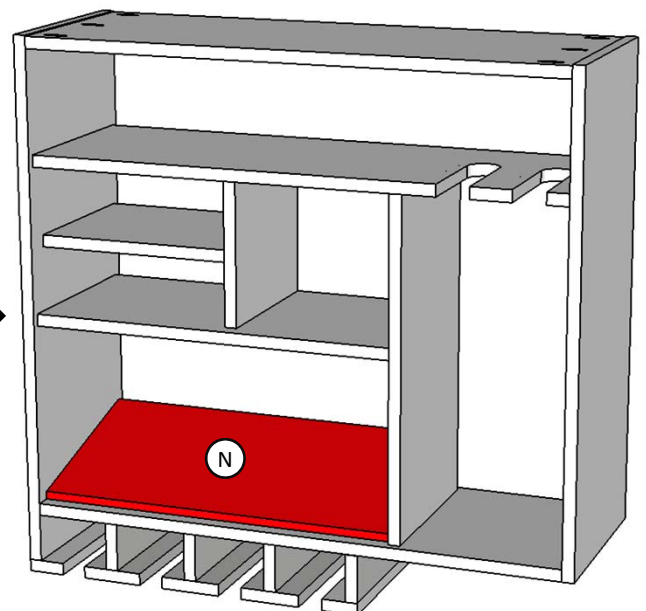

**Step 13:** Cut the battery charging platform (N) to width and then use an angle gauge to transfer the angle of the cleat to the table saw to cut the platform to depth. This ensures the front and back edges of the panel will be vertical after it's secured in place.

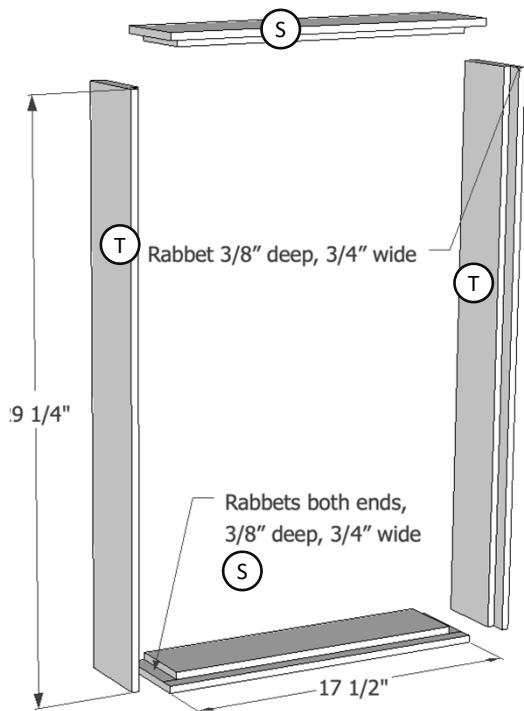
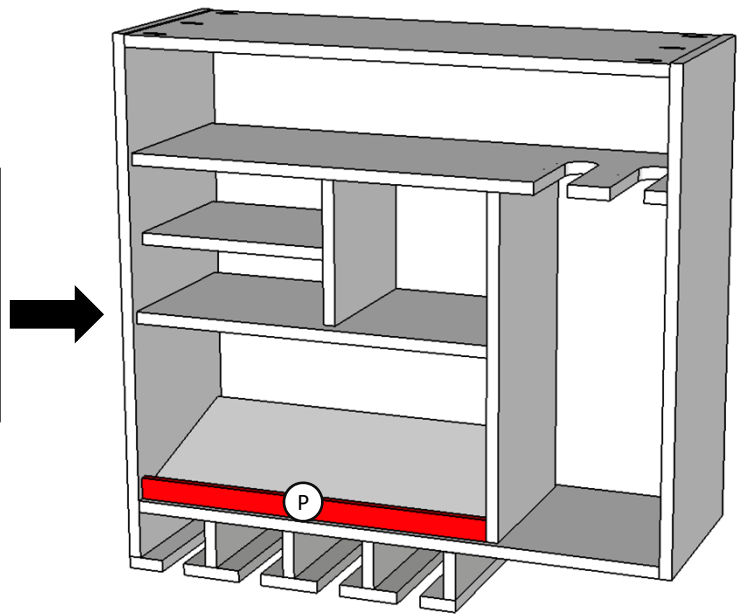

**Step 14:** The door assembly is the same for both doors, so only one will be shown here. After the door rails (S) and stiles (T) are cut to size, all parts will receive a rabbet along the long edges for receiving the door panel. The rails will then receive a rabbet on both ends for joining to the stiles. Attach the pieces together with glue and clamps.

**Step 15:** Cut the door panels (L) to size to fit in the groove created by the dados in the rails and stiles. Attach to the door frame assembly using glue and clamps.

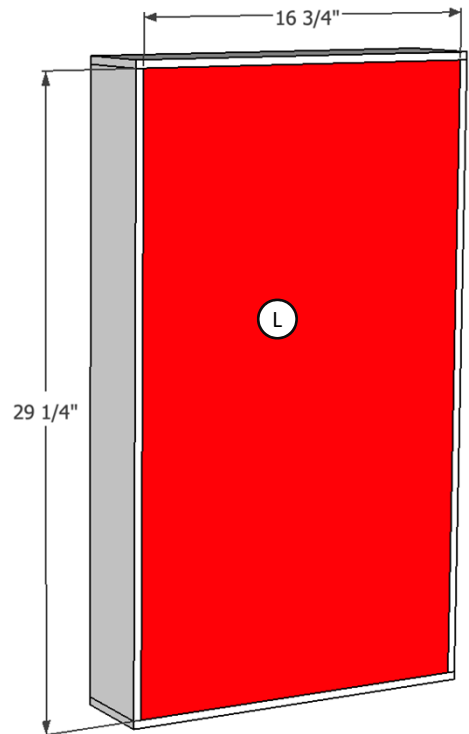



**Step 16:** Cut the door shelves (K) to fit between the door stiles. Drill pocket holes on each end of the shelves as well as the back edge. Use spacer blocks to position the shelves and then attach them to the door assembly.

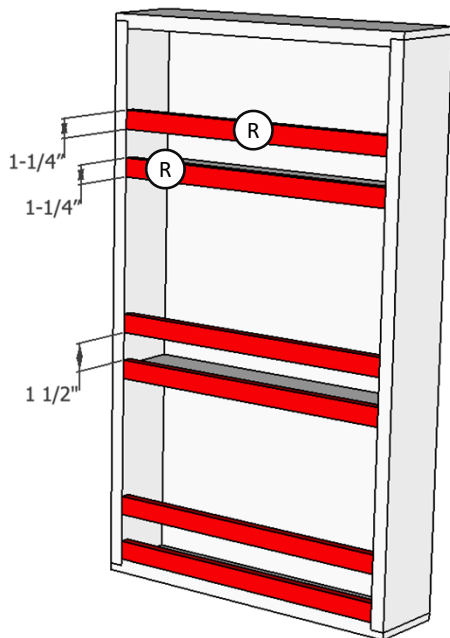
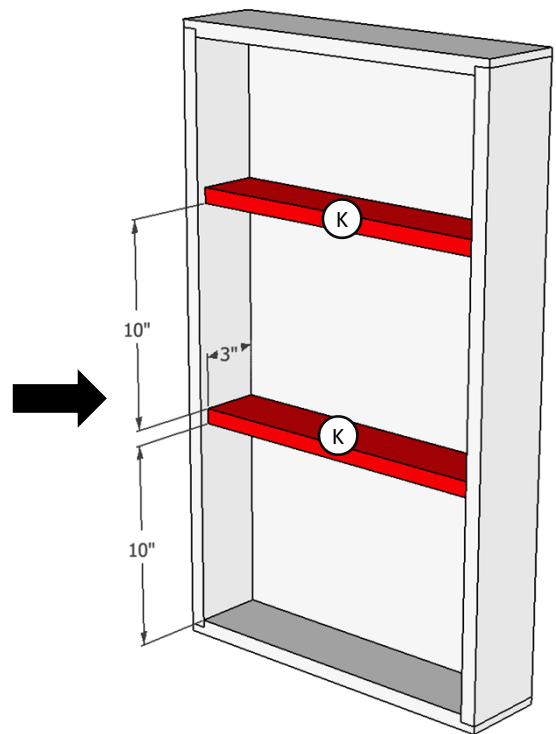

**Step 17:** Cut the shelf rail (R) pieces to fit in between door rails. These can be cut to length at the same time as the shelves in the previous step since they are the same length. The bottom edge of one of the rails will be flush to the bottom face of the shelves attached previously. The other rails will be positioned 1-1/2" above the lower rails. These will all be only attached using glue and clamps.

**Step 18:** Lay the case flat on the workbench, with the front facing up. Lay the cabinet doors on top and attach the piano hinges on the outside.

